

Air Ride System Shock Unit Assembly

COLOURS
IN MOTION

Ver.1 01/31/13
Section 3400

Air Suspension Unit Assembly

* When converting from (old style) spring suspension system to the new AirRide system, additional parts are required (camber discs and mounting hardware. see section 1200)

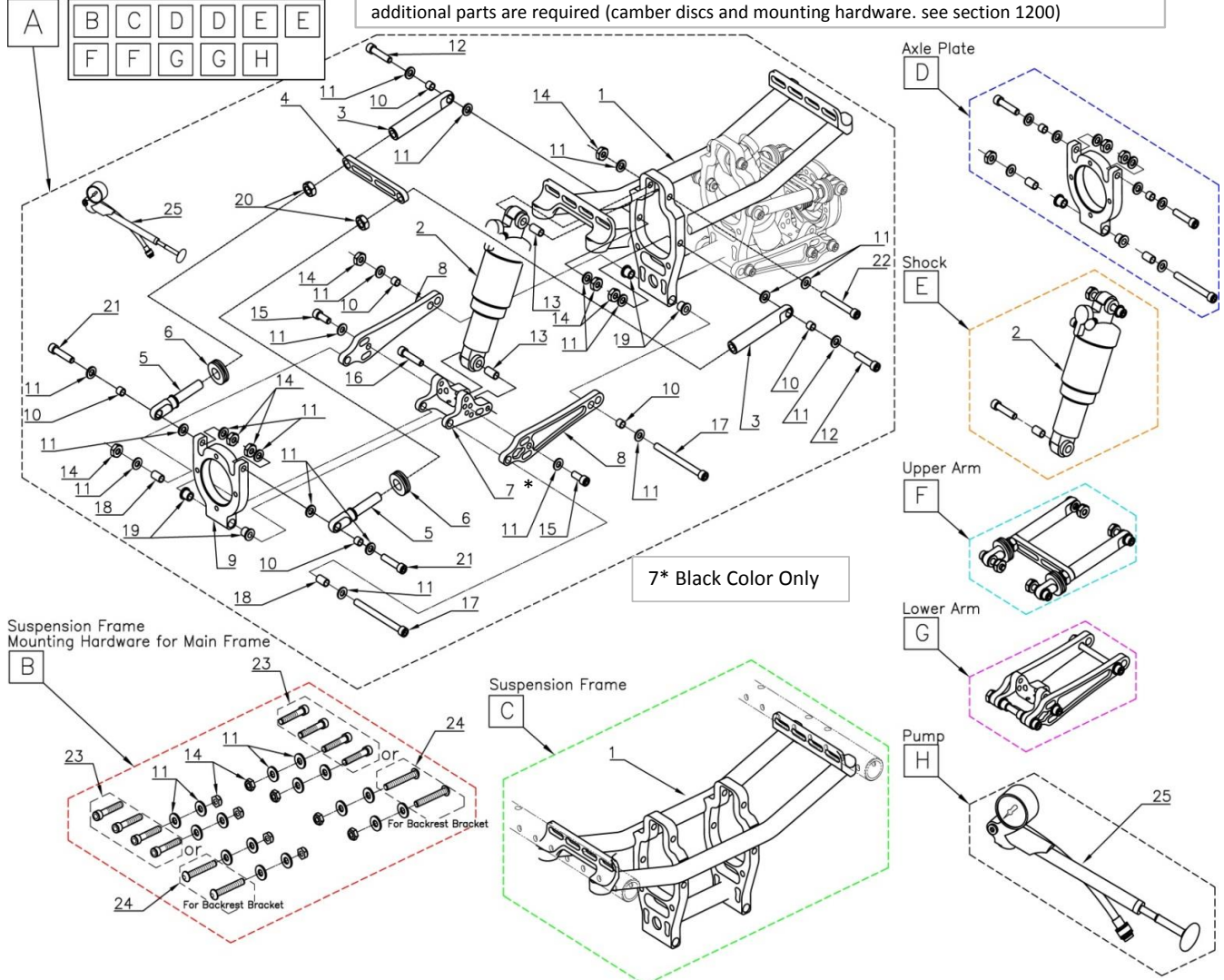

POS	Assy #	#	Parts #	QTY	Color	Remark	MSRP	NOTE	POS	Assy #	#	Parts #	QTY	Color	Remark	MSRP	Note			
A	3400-01A	-	-	1	Blk	Air Suspension Unit Assembly	All Black Color (STD)	1set/chair	E	3400-01E	8	0194-120	1	-	FOX FLOAT EVOLUTION 6.5"	\$460/1set	2set/chair			
						\$2290/1set	1set/chair	11				0277-300	2	Sil	1/4" Washer					
						Powder Coated Color	Add \$500	13				0257-303	2	Br	S.Bearing OD5/16" x L3/4"					
						one color only	14	0278-300				1	Sil	1/4"-20 HLN Pinched Top						
						Polish		16	0115-300	1	Sil	1/4"-20 L:1 3/4" SHCS								
						Add \$900		22	0376-300	1	Sil	1/4"-20 L:2" SHCS								
B	3400-01B		23	0313-300	8	Sil	1/4"-20 L:1 1/2" SHCS	\$40/1set	1set/chair	F	3400-01F	3	0194-115	2	Blk	Suspension Arm B	Black Color			
			24	0112-301	4	Sil	1/4" -20 L:2"BHCS						4	0194-116	2	Blk	Suspension Arm D	\$480/1pair	1 pair/chair	
			11	0277-300	16	Sil	1/4" Washer						5	0194-117	2	Blk	Suspension Arm C	Powder Coated Color		
			14	0278-300	8	Sil	1/4"-20 HLN Pinched Top						6	0257-304	2	Blk	Rubber Grommet	Add \$100/pair	1pair/chair	
C	3400-01C	1	-	1	-	13" Seat Width	Black Color (STD)	\$480/1pcs	1pcs/chair	G	3400-01G	10	0273-300	4	Br	S.Bearing OD5/16" x L1/4"	Powder Coated Color			
						14" Seat Width	\$480/1pcs						1pcs/chair	11	0277-300	12	Sil	1/4" Washer	Polish Color	
						15" Seat Width	Powder Coated Color						12	0319-299	2	Sil	1/4"-20 L:1 1/8" SHCS	Add \$300/Pair	1pair/chair	
						16" Seat Width	Add \$100						14	0278-300	4	Sil	1/4"-20 HLN Pinched Top			
						17" Seat Width	Polish Color						20	0309-300	2	Sil	3/8"-24 Thin Nut			
						18" Seat Width	Add \$340						21	0110-300	2	Sil	1/4"-20 L:1" SHCS			
D	3400-01D		9	0194-111	1	Blk	Axle Plate	Black Color (STD)	H			7	0194-112	1	Blk	Mount (Black color only)	Black Color			
			19	0257-301	2	Br	F.S.Bearing OD3/8" x L3/8"	\$360/pair					1pair/chair	8	0194-114	2	Blk	Suspension Arm A	\$420/Pair	1pair/chair
			18	0257-302	2	Br	S.Bearing OD5/16" x L1/2"	Powder Coated Color					10	0273-300	2	Br	S.Bearing OD5/16" x L1/4"	Powder Coated Color		
			10	0273-300	2	Br	S.Bearing OD5/16" x L1/4"	Add \$60/pair					1pair/chair	11	0277-300	6	Sil	1/4" Washer	Add \$100/Pair	1pair/chair
			11	0277-300	8	Sil	1/4" Washer	13					0257-303	1	Br	S.Bearing OD5/16" x L3/4"	Polish Color			
			14	0278-300	3	Sil	1/4"-20 HLN Pinched Top	14					0278-300	2	Sil	1/4"-20 HLN Pinched Top	Add \$280/Pair	1pair/chair		
			17	0114-301	1	Sil	1/4"-20 L:3" SHCS	15					0501-300	2	Sil	1/4"-20 L:3/4" SHCS				
			21	0110-300	2	Sil	1/4"-20 L:1 1/8" SHCS	Add \$150/pair					1pair/chair	16	0115-300	1	Sil	1/4"-20 L:1 3/4" SHCS		
							17	0114-301	1	Sil	1/4"-20 L:3" SHCS									
							18	0257-302	2	Br	S.Bearing OD5/16" x L1/2"									
							19	0257-301	2	Br	F.S.Bearing OD3/8" x L3/8"									
												25	0194-121	1	-	Fox 300 HP Pump	\$65/1pcs	1pcs/chair		